

SPECIFICATIONS :

- Suitable Rated Current : Maximum Installation Rating
- Existing Circuit : 20A
- Add-on Circuit : 20A
- Dielectric Strength for 60 seconds : AC1500V Min.
- Insertion & Extraction Force : 1Kg. Min.
- Contact Resistance at 1A DC : 5mΩ Max.
- Insulation Resistance at 500V DC : 100MΩ Min.
- Voltage Drop : 20mV Max.
- Temperature Rise : 50°C Max.
- Molded Parts : Nylon with glassfiber UL 94V-0, Black
- Terminals : Brass with Tin Plated
- Wire : #14 AWG UL 1015 Red Wire, End With Insulated Crimp-Type coupler Blue Butt Connector
- **Other color option is available for "Molded Parts" and "Wire"

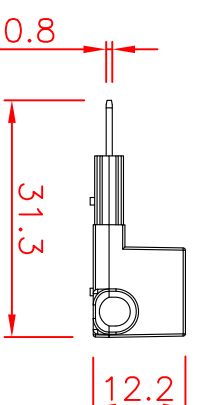

Tolerances : Unless Otherwise Specified		Critical To Function		General		
Dimension	< 1	+/- 0.02	+/- 0.03			
	1 ~ 8	+/- 0.1	+/- 0.2			
	8 ~ 24.995	+/- 0.15	+/- 0.25			
	25 ~ 99.99	+/- 0.2	+/- 0.3			
Angles		+/- 1°	+/- 5°			
Rev	EN	Description	Dwg	Ckd	Appd	Date
B	93092401	Modify the tolerance	Kao	Chyi	Ku	2004/9/24

Material		Drawn	GLORYTECH TECHNOLOGY CO., LTD.		
Finish		Check			
Unless Otherwise Specified Dimensions are mm (inch) Tolerances: .x = 1.0 (.04) .xx = 0.5 (.02) .xxx = 0.25 (.010)		Engr			
Title:		Appd	Micro 3 Tap		
Model File Name : Fuse Tap for Micro 3 Fuse ; #14 AWG Wire		Scale:	1:1	Dwg Size	A4
Drawing File Name : GTQD-HLD-1829-1401-400		Sht	1	of	1
Part Number : 1829 1401 400		Date:	2017/1/13		
		Rev	B		