

SPECIFICATIONS :

- Suitable Rated Current : Maximum Installation Rating
- Existing Circuit : 30A
- Add-on Circuit : 15A
- Dielectric Strength for 60 seconds : AC1500V Min.
- Insertion & Extraction Force : 1Kg. Min.
- Contact Resistance at 1A DC : 5mΩ Max.
- Insulation Resistance at 500V DC : 100MΩ Min.
- Voltage Drop : 20mV Max.
- Temperature Rise : 50°C Max.
- Molded Parts : Nylon PA66 UL 94V-0, Red
- Terminals : Brass with Tin Plated
- Wire : #18 AWG UL 1015 Red Wire.
- **Other color option is available for "Molded Parts" and "Wire"

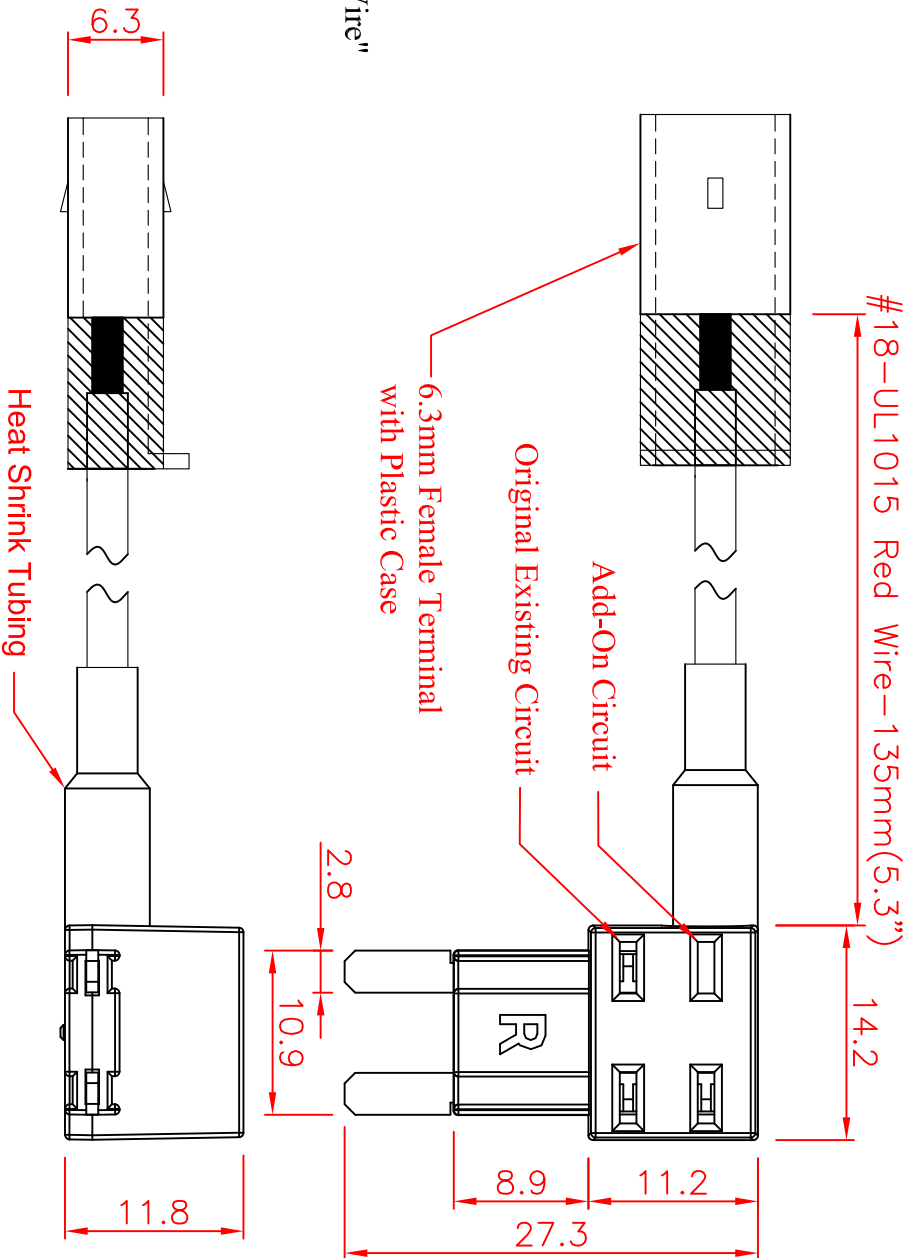
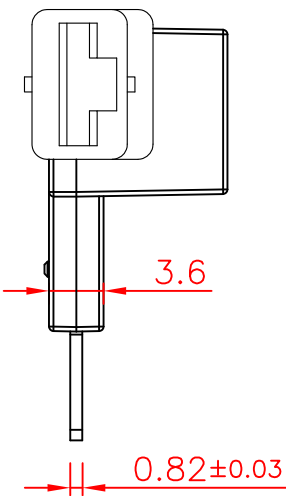

| Tolerances : Unless Otherwise Specified | | Critical To Function | | General | |
|---|------------|----------------------|----------|----------|----------|
| Dimension | < 1 | +/- 0.02 | +/- 0.03 | +/- 0.03 | +/- 0.03 |
| | 1 ~ 8 | +/- 0.1 | +/- 0.2 | +/- 0.2 | +/- 0.2 |
| | 8 ~ 24.995 | +/- 0.15 | +/- 0.25 | +/- 0.25 | +/- 0.25 |
| | 25 ~ 99.99 | +/- 0.2 | +/- 0.3 | +/- 0.3 | +/- 0.3 |
| Angles | | +/- 1° | +/- 5° | +/- 5° | +/- 5° |

| Rev | EN | Description | Dwg | Ckd | Appd | Date |
|-----|----------|----------------------|-----|------|------|-----------|
| B | 93092401 | Modify the tolerance | Kao | Chyi | Ku | 2004/9/24 |

| Material | Drawn | Title: | Dwg | Sht | of | Rev |
|--|-------|---|--------|------------------------|----|-----|
| | Check | | | | | |
| Finish | Appd | Mini Blade Fuse Tap (Right Side Insert Fuse) | A4 | GTQD-HLD-1829-1115-401 | B | |
| Unless Otherwise Specified Dimensions are mm (inch) | | | | | | |
| Tolerances: | | | | | | |
| .x = 1.0 (.04) | | | | | | |
| .xx = 0.5 (.02) | | | | | | |
| .xxx = 0.25 (.010) | | | | | | |
| Model File Name : Mini Blade Fuse Tap ; #18AWG ; Right Side Insert | | | Scale: | 2:1 | | |
| Drawing File Name : GTQD-HLD-1829-1115-401 | | | Date: | 2015/7/17 | | |
| Part Number : 1829 1115 401 | | | | | | |