

SPECIFICATIONS :

- Suitable Rated Current : Maximum Installation Rating
- Existing Circuit : 30A
- Add-on Circuit : 15A
- Dielectric Strength for 60 seconds : AC1500V Min.
- Insertion & Extraction Force : 1Kg. Min.
- Contact Resistance at 1A DC : 5mΩ Max.
- Insulation Resistance at 500V DC : 100MΩ Min.
- Voltage Drop : 20mV Max.
- Temperature Rise : 50°C Max.
- Molded Parts : Nylon PA66 UL 94V-0, Red
- Terminals : Brass with Tin Plated
- Wire : #18 AWG UL 1015 Red Wire, End With Insulated Crimp-Type coupler Blue Butt Connector.
- **Other color option is available for "Molded Parts" and "Wire"

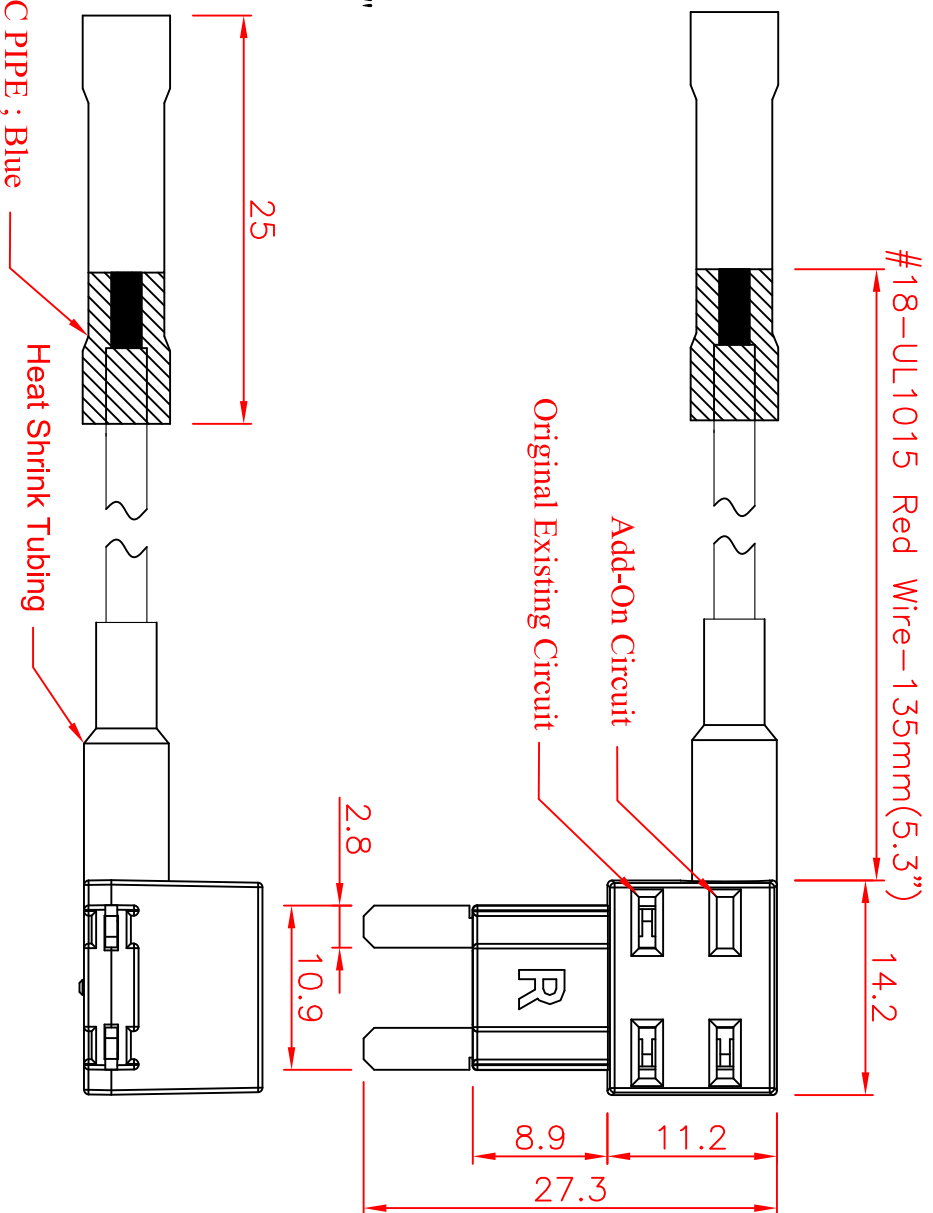
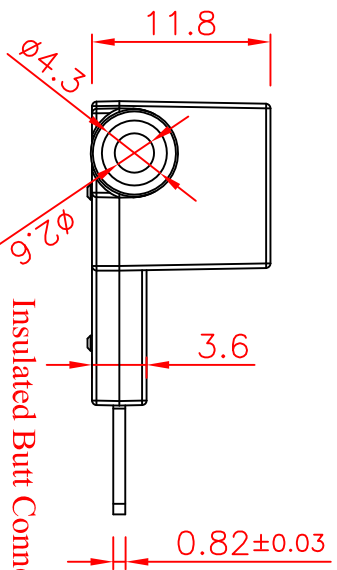

Tolerances : Unless Otherwise Specified	
Dimension	Critical To Function
< 1	+/- 0.02
1 ~ 8	+/- 0.1
8 ~ 24.995	+/- 0.15
25 ~ 99.99	+/- 0.2
Angles	+/- 1°

Rev	EN	Description	Dwg	Ckd	Appd	Date
B	93092401	Modify the tolerance	Kao	Chyi	Ku	2004/9/24

Material	Drawn	Title:	Dwg	Sht	1	of	1	Rev
	Check							
Finish	Engr	Mini Blade Fuse Tap (Right Side Insert Fuse)	A4	GTQD-HLD-1829-1115-400	B			
	Appd							
Unless Otherwise Specified Dimensions are mm (inch)		Tolerances:		Scale:				
.x = 1.0 (.04)		.xx = 0.5 (.02)		.xxx = 0.25 (.010)				
Material		GLORYTECH TECHNOLOGY CO., LTD.		Model File Name : Mini Blade Fuse Tap ; #18AWG ; Right Side Insert				
Finish				Drawing File Name : GTQD-HLD-1829-1115-400				
Tolerances:				Part Number : 1829 1115 400				
.x = 1.0 (.04)				Date:		2015/7/17		
.xx = 0.5 (.02)								
.xxx = 0.25 (.010)								