

**SPECIFICATIONS :**

- Suitable Rated Current : Maximum Installation Rating
- Existing Circuit : 30A
- Add-on Circuit : 15A
- Dielectric Strength for 60 seconds : AC1500V Min.
- Insertion & Extraction Force : 1Kg. Min.
- Contact Resistance at 1A DC : 5mΩ Max.
- Insulation Resistance at 500V DC : 100MΩ Min.
- Voltage Drop : 20mV Max.
- Temperature Rise : 50°C Max.
- Molded Parts : Nylon PA66 UL 94V-0, Black
- Terminals : Brass with Tin Plated
- Wire : #18 AWG UL 1015 Red Wire, End With Insulated Crimp-Type coupler Blue Butt Connector.
- \*\*Other color option is available for "Molded Parts" and "Wire"

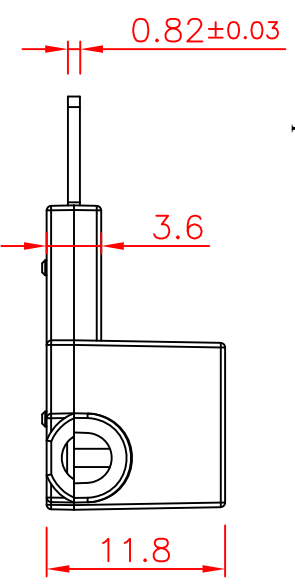
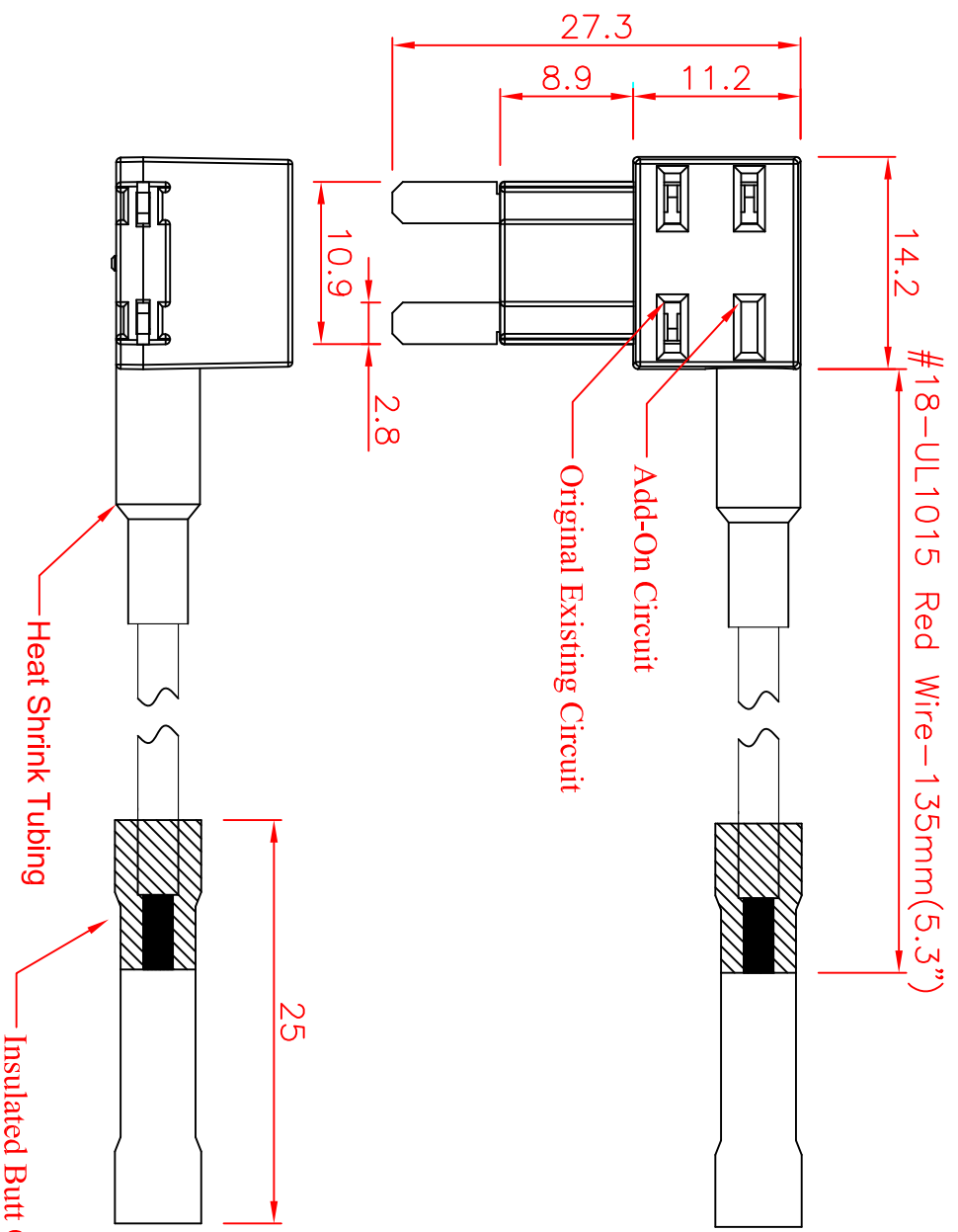

Tolerances : Unless Otherwise Specified	
Dimension	Critical To Function
< 1	+/- 0.02
1 ~ 8	+/- 0.1
8 ~ 24.995	+/- 0.15
25 ~ 99.99	+/- 0.2
Angles	+/- 1°
Rev	EN
93092401	Modify the tolerance
	Dwg Kao
	Ckd Chyi
	Appd Ku
	Date 2004/9/24

Material		Material		Material	
Drawn	Check	Engr	Appd	Drawn	Check
Finish		Title:		GLORYTECH TECHNOLOGY CO., LTD.	
Unless Otherwise Specified Dimensions are mm (inch)		Mini Blade Fuse Tap (Left Side Insert Fuse)		A4 GTQD-HLD-1829-1114-400	
Tolerances:		Scale:		Dwg Size	
.x = 1.0 (.04)		2:1		Sht 1 of 1	
.xx = 0.5 (.02)				Rev	
.xxx = 0.25 (.010)				Date: 2015/7/17	
Model File Name : Mini Blade Fuse Tap ; #18AWG ; Left Side Insert					
Drawing File Name : GTQD-HLD-1829-1114-400					
Part Number : 1829 1114 400					