

**SPECIFICATIONS :**

- Suitable Rated Current : Maximum Installation Rating
- Existing Circuit : 30A
- Add-on Circuit : 25A
- Dielectric Strength for 60 seconds : AC1500V Min.
- Insertion & Extraction Force : 1Kg. Min.
- Contact Resistance at 1A DC : 5mΩ Max.
- Insulation Resistance at 500V DC : 100MΩ Min.
- Voltage Drop : 20mV Max.
- Temperature Rise : 50°C Max.
- Molded Parts : Nylon PA66 UL 94V-0, Red
- Terminals : Brass with Tin Plated
- Wire : #14 AWG UL 1015 Red Wire, End With Insulated Crimp-Type coupler Blue Butt Connector.
- \*\*Other color option is available for "Molded Parts" and "Wire"

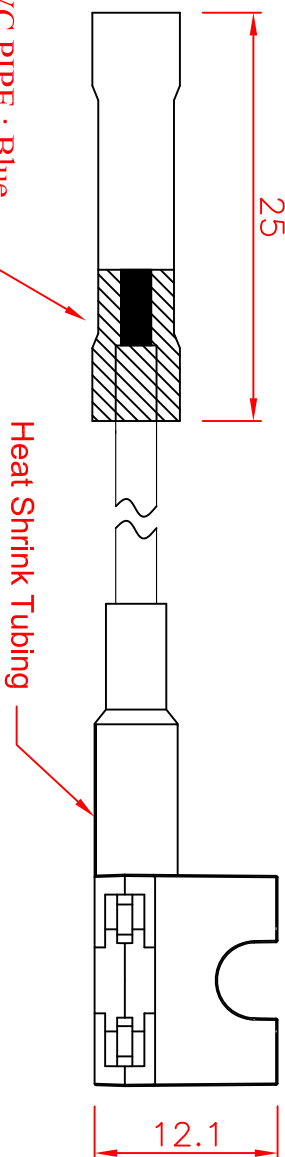
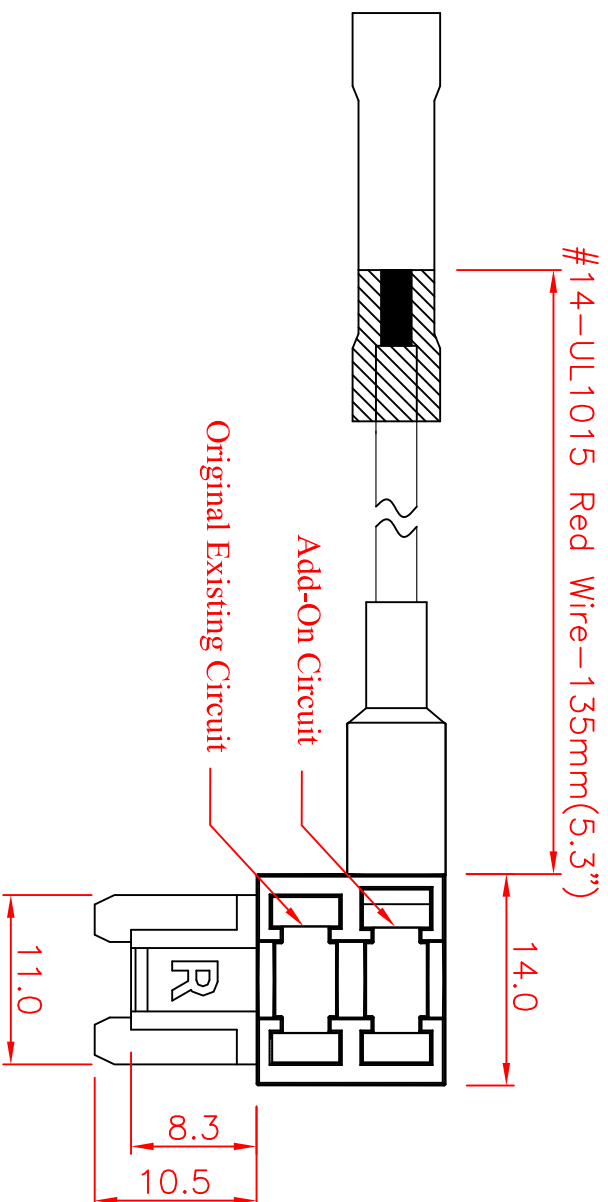
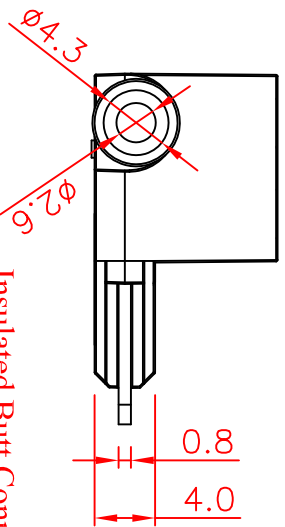

Tolerances : Unless Otherwise Specified		Critical To Function		General		
Dimension	< 1		+/- 0.02		+/- 0.03	
	1 ~ 8		+/- 0.1		+/- 0.2	
	8 ~ 24.995		+/- 0.15		+/- 0.25	
	25 ~ 99.99		+/- 0.2		+/- 0.3	
Angles			+/- 1°		+/- 5°	
Rev	EN	Description	Dwg	Ckd	Appd	Date
B	93092401	Modify the tolerance	Kao	Chyi	Ku	2004/9/24

Material		Drawn	Title:		
Check		Engr	Low Profile Fuse Tap		
Appd		Appd	(Right Side Insert Fuse)		
Finish		Unless Otherwise Specified Dimensions are mm (inch)		A4	GTQD-HLD-1829-1113-400
Tolerances:		Scale:		Dwg Size	Sht 1 of 1
.x = 1.0 (.04)		2:1		Rev	B
.xx = 0.5 (.02)				Model File Name : Low Profile Fuse Tap ; #14AWG ; Right Side Insert	
.xxx = 0.25 (.010)				Drawing File Name : GTQD-HLD-1829-1113-400	
				Part Number : 1829 1113 400	
				Date:	2015/5/6

**GLORYTECH TECHNOLOGY CO., LTD.**