

**SPECIFICATIONS :**

- Suitable Rated Current : Maximum Installation Rating
- Existing Circuit : 30A
- Add-on Circuit : 20A
- Dielectric Strength for 60 seconds : AC1500V Min.
- Insertion & Extraction Force : 1Kg. Min.
- Contact Resistance at 1A DC : 5mΩ Max.
- Insulation Resistance at 500V DC : 100MΩ Min.
- Voltage Drop : 20mV Max.
- Temperature Rise : 50°C Max.
- Molded Parts : Nylon PA66 UL 94V-0, Red
- Terminals : Brass with Tin Plated
- Wire : #16 AWG UL 1015 Red Wire.
- \*\*Other color option is available for "Molded Parts" and "Wire"

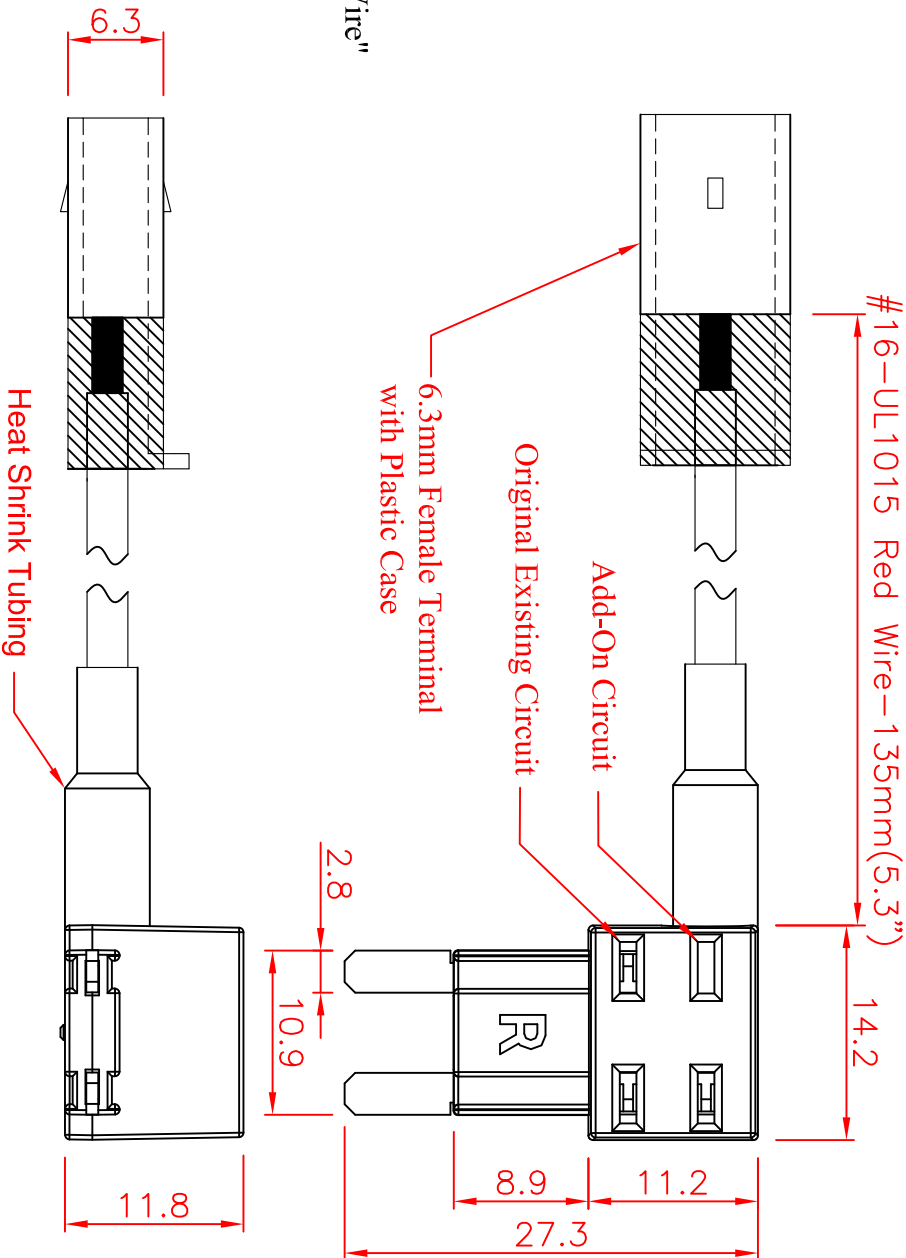
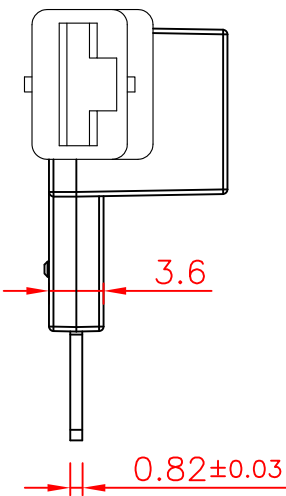

Tolerances : Unless Otherwise Specified		Critical To Function		General	
Dimension	< 1	+/- 0.02		+/- 0.03	
	1 ~ 8	+/- 0.1		+/- 0.2	
	8 ~ 24.995	+/- 0.15		+/- 0.25	
	25 ~ 99.99	+/- 0.2		+/- 0.3	
Angles		+/- 1°		+/- 5°	

Rev	EN	Description	Dwg	Ckd	Appd	Date
B	93092401	Modify the tolerance	Kao	Chyi	Ku	2004/9/24

Material		Finish		Title:		Scale:		Dwg Size		Sht		Rev	
Drawn	Check	Engr	Appd	Mini Blade Fuse Tap (Right Side Insert Fuse)		2:1		A4		1 of 1		B	
Unless Otherwise Specified Dimensions are mm (inch)				GLORYTECH TECHNOLOGY CO., LTD.				GTQD-HLD-1829-1109-401					
Tolerances: .x = 1.0 (.04) .xx = 0.5 (.02) .xxx = 0.25 (.010)													
Model File Name : Mini Blade Fuse Tap ; #16AWG ; Right Side Insert						Drawing File Name : GTQD-HLD-1829-1109-401						Date: 2015/7/17	
Part Number : 1829 1109 401													