

SPECIFICATIONS :

- Suitable Rated Current : Maximum Installation Rating
 - Existing Circuit : 30A
 - Add-on Circuit : 25A
 - Dielectric Strength for 60 seconds : AC1500V Min.
 - Insertion & Extraction Force : 1Kg. Min.
 - Contact Resistance at 1A DC : 5mΩ Max.
 - Insulation Resistance at 500V DC : 100MΩ Min.
 - Voltage Drop : 20mV Max.
 - Temperature Rise : 50°C Max.
 - Molded Parts : Nylon PA66 UL 94V-0, Red
 - Terminals : Brass with Tin Plated
 - Wire : #14 AWG UL 1015 Red Wire.
- **Other color option is available for "Molded Parts" and "Wire"**

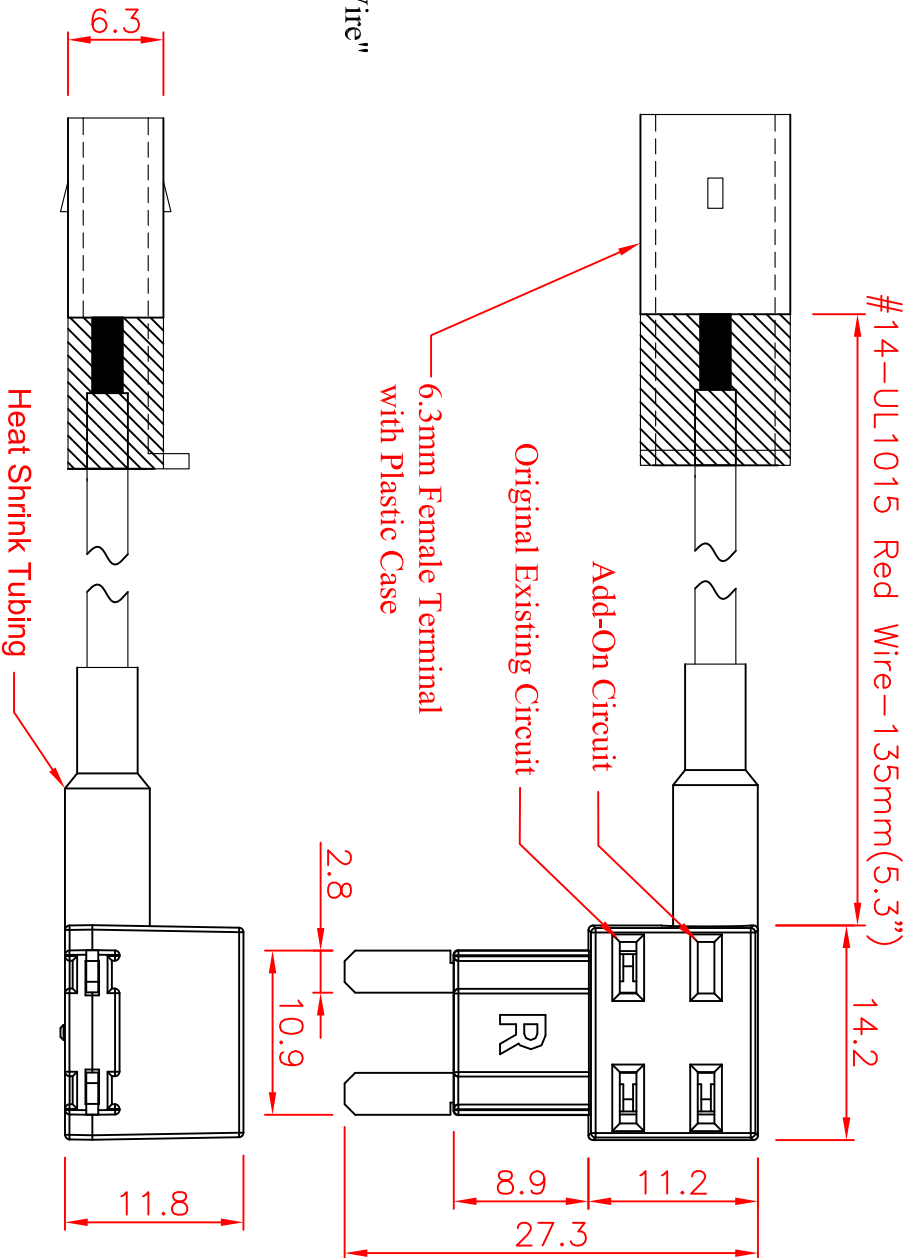
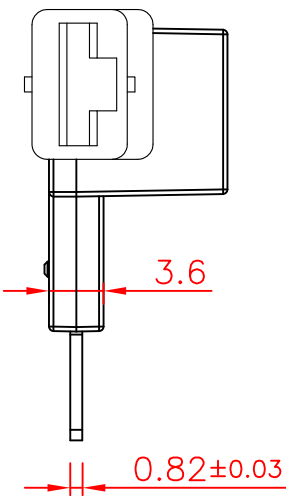

| Tolerances : Unless Otherwise Specified | | Critical To Function | | General | |
|---|------------|----------------------|--|----------|--|
| Dimension | < 1 | +/- 0.02 | | +/- 0.03 | |
| | 1 ~ 8 | +/- 0.1 | | +/- 0.2 | |
| | 8 ~ 24.995 | +/- 0.15 | | +/- 0.25 | |
| | 25 ~ 99.99 | +/- 0.2 | | +/- 0.3 | |
| Angles | | +/- 1° | | +/- 5° | |

| Rev | EN | Description | Dwg | Ckd | Appd | Date |
|-----|----------|----------------------|-----|------|------|-----------|
| B | 93092401 | Modify the tolerance | Kao | Chyi | Ku | 2004/9/24 |

| Material | Drawn | Title: | Dwg | Sht | of | Rev |
|----------|-------|---|-----|------------------------|----|-----|
| | Check | | | | | |
| Finish | Engr | Mini Blade Fuse Tap (Right Side Insert Fuse) | A4 | GTQD-HLD-1829-1108-401 | B | |
| | Appd | | | | | |

Unless Otherwise Specified Dimensions are mm (inch)
Tolerances:
.x = 1.0 (.04)
.xx = 0.5 (.02)
.xxx = 0.25 (.010)
Scale: 2:1

| | |
|--|-----------|
| Model File Name : Mini Blade Fuse Tap ; #14AWG ; Right Side Insert | Date: |
| Drawing File Name : GTQD-HLD-1829-1108-401 | 2015/7/17 |
| Part Number : 1829 1108 401 | |