

SPECIFICATIONS :

Suitable Rated Current : Maximum Installation Rating

- Existing Circuit : 30A
 - Add-on Circuit : 15A
 - Dielectric Strength for 60 seconds : AC1500V Min.
 - Insertion & Extraction Force : 1Kg. Min.
 - Contact Resistance at 1A DC : 5mΩ Max.
 - Insulation Resistance at 500V DC : 100MΩ Min.
 - Voltage Drop : 20mV Max.
 - Temperature Rise : 50°C Max., Red
 - Molded Parts : Nylon PA66 UL 94V-0, Red
 - Terminals : Brass with Tin Plated
 - Wire : #18 AWG UL 1015 Red Wire
- **Other color option is available for "Molded Parts" and "Wire"**

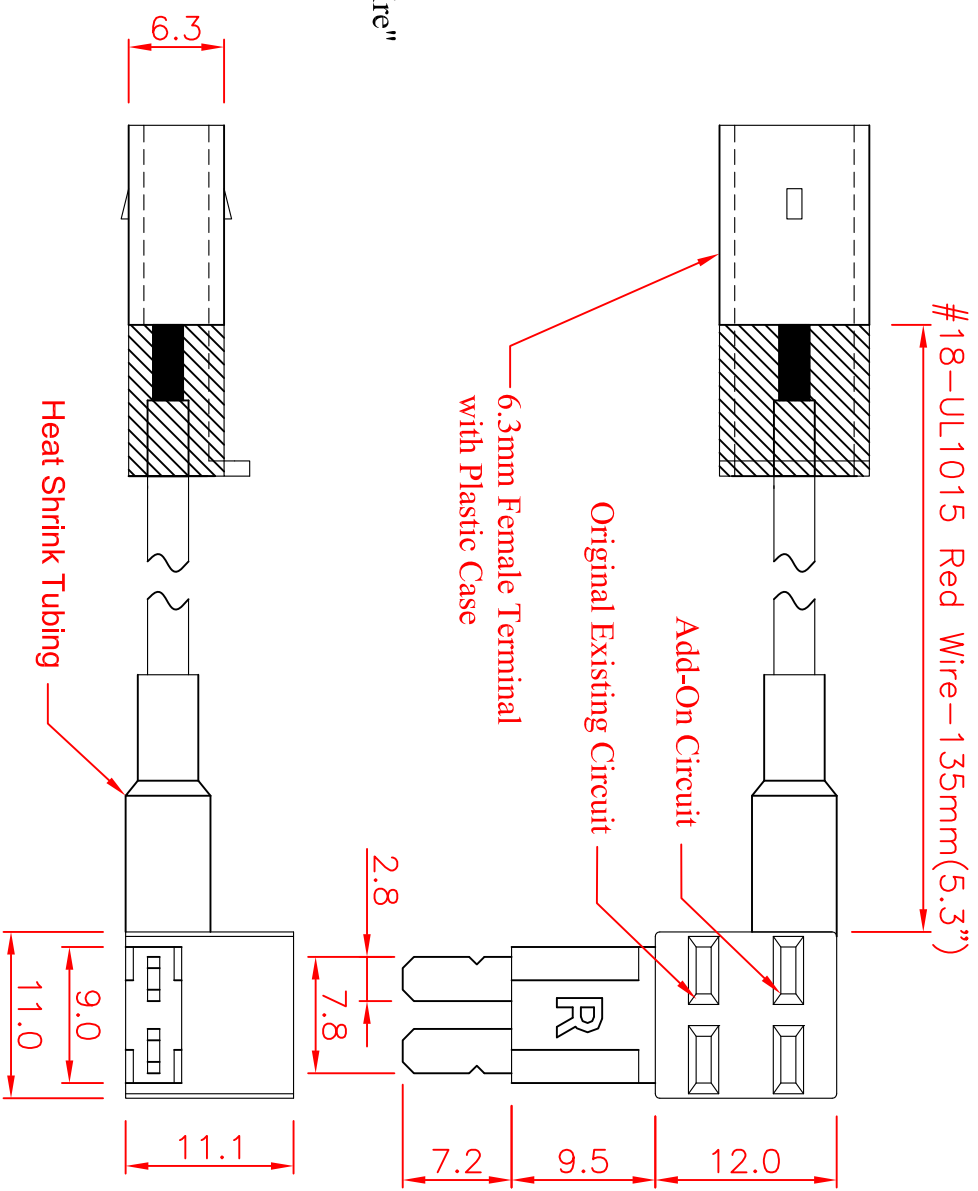
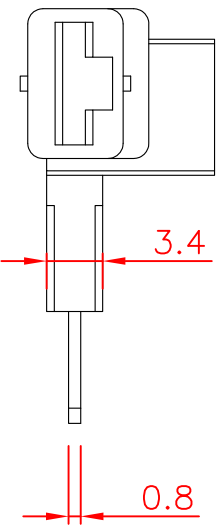

Tolerances : Unless Otherwise Specified	
Dimension	Critical To Function
< 1	+/- 0.02
1 ~ 8	+/- 0.1
8 ~ 24.995	+/- 0.15
25 ~ 99.99	+/- 0.2
Angles	+/- 1°

Rev	EN	Description	Dwg	Ckd	Appd	Date
B	93092401	Modify the tolerance	Kao	Chyi	Ku	2004/9/24

Material		Finish		Title:		Dwg Size		Sht		Rev	
Drawn	Check	Engr	Appd	Tiny Fuse (Micro 2)Tap (Right Side Insert Fuse)		A4	GTQD-HLD-1829-0906-401	1	of	1	B
Unless Otherwise Specified Dimensions are mm (inch)				Tolerances:				Scale: 2:1			
.x = 1.0 (.04)				.xx = 0.5 (.02)				Dwg Size			
.xxx = 0.25 (.010)								Date: 2015/7/7			
Model File Name : Fuse Tap for Tiny Blade Fuse ; #18 AWG Wire ; Right Side Insert											
Drawing File Name : GTQD-HLD-1829-0906-401											
Part Number : 1829 0906 401											

GLORYTECH TECHNOLOGY CO., LTD.