

#18-UL1015 Red Wire—135mm(5.3")

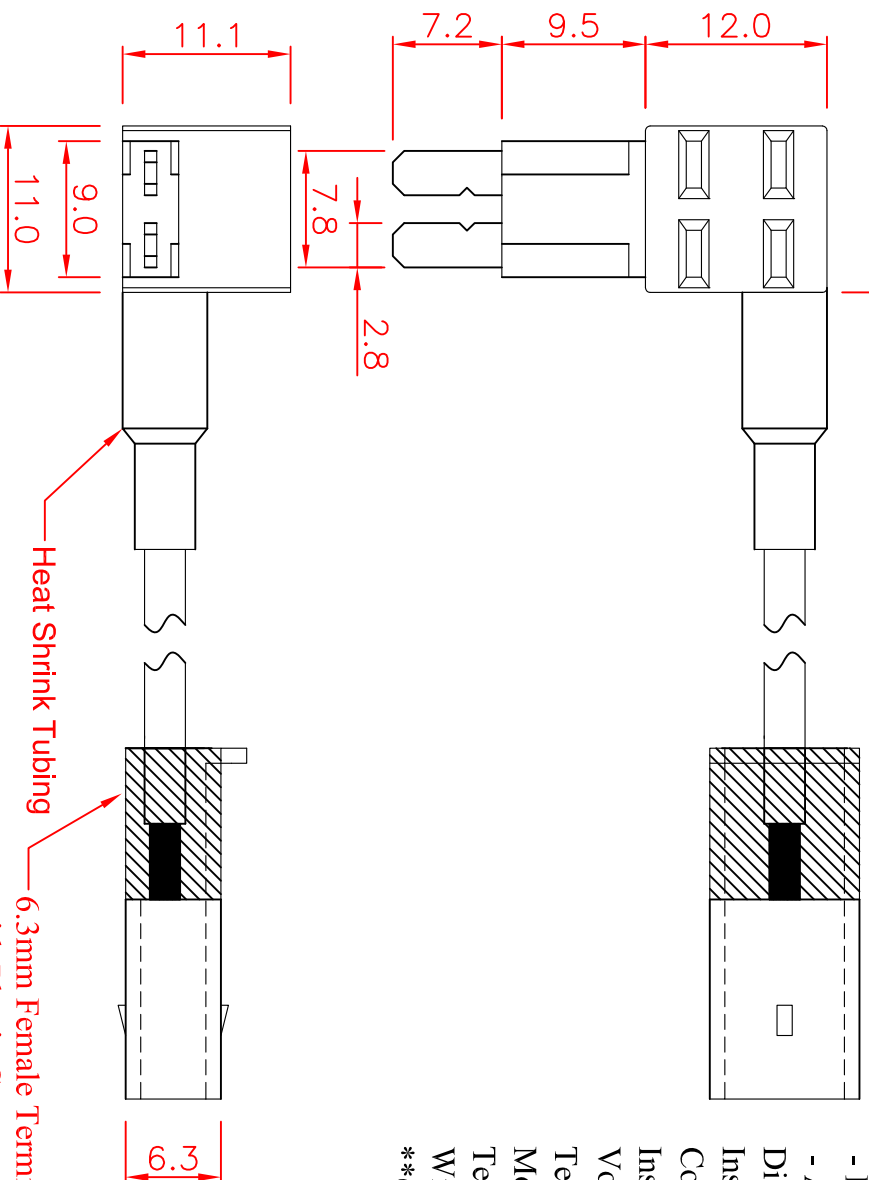

SPECIFICATIONS :

Suitable Rated Current : Maximum Installation Rating

- Existing Circuit : 30A

- Add-on Circuit : 15A

Dielectric Strength for 60 seconds : AC1500V Min.

Insertion & Extraction Force : 1Kg. Min.

Contact Resistance at 1A DC : 5mΩ Max.

Insulation Resistance at 500V DC : 100MΩ Min.

Voltage Drop : 20mV Max.

Temperature Rise : 50°C Max.

Molded Parts : Nylon PA66 UL 94V-0, Black

Terminals : Brass with Tin Plated

Wire : #18 AWG UL 1015 Red Wire.

**Other color option is available for "Molded Parts" and "Wire"

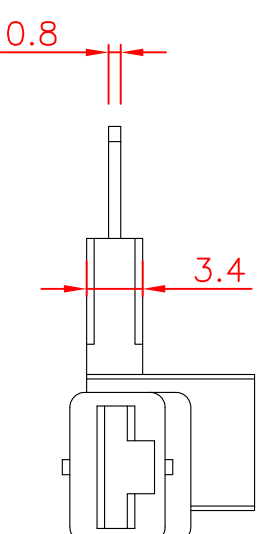

Tolerances : Unless Otherwise Specified		Critical To Function		General		
Dimension	< 1		+/- 0.02		+/- 0.03	
	1 ~ 8		+/- 0.1		+/- 0.2	
	8 ~ 24.995		+/- 0.15		+/- 0.25	
	25 ~ 99.99		+/- 0.2		+/- 0.3	
Angles			+/- 1°		+/- 5°	
Rev	EN	Description	Dwg	Ckd	Appd	Date
B	93092401	Modify the tolerance	Kao	Chyi	Ku	2004/9/24

Material		Drawn	Title:		
Check		Engr	Tiny Fuse(Micro 2) Tap		
Appd		Appd	(Left Side Insert Fuse)		
Finish			A4	GTQD-HLD-1829-0905-401	B
Unless Otherwise Specified Dimensions are mm (inch)					
Tolerances:					
.x = 1.0 (.04)					
.xx = 0.5 (.02)					
.xxx = 0.25 (.010)					
Scale:		2:1	Dwg Size	Sht	1 of 1
Model File Name : Fuse Tap for Tiny Blade Fuse ; #18AWG Wire ; Left Side Insert					Rev
Drawing File Name : GTQD-HLD-1829-0905-401					
Part Number : 1829 0905 401					Date: 2013/9/4

GLORYTECH TECHNOLOGY CO., LTD.