

#14-UL1015 Red Wire-135mm(5.3")

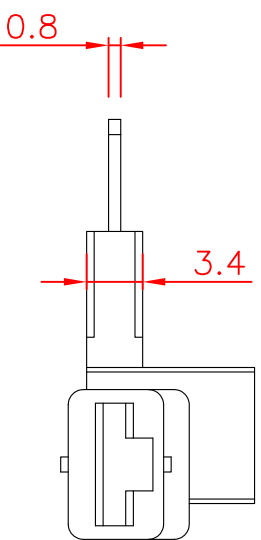
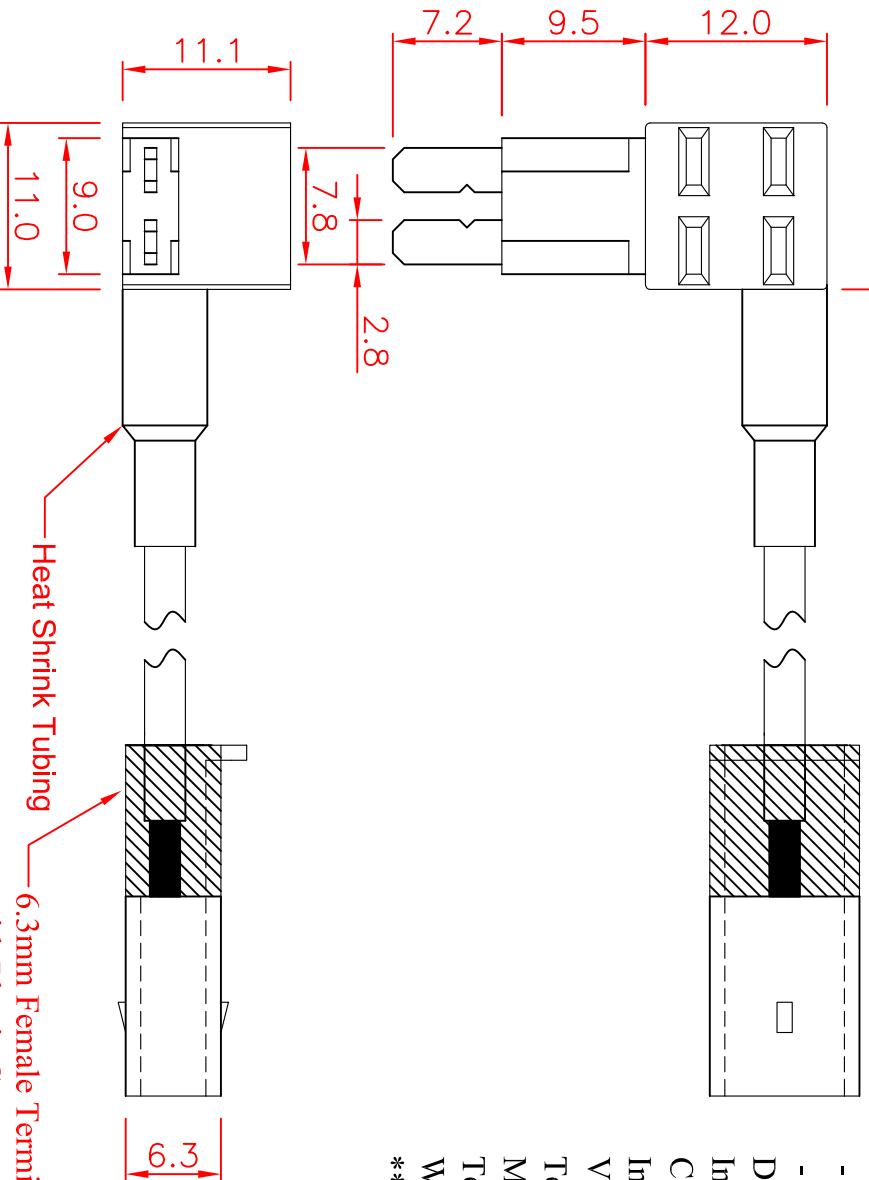

SPECIFICATIONS :

- Suitable Rated Current : Maximum Installation Rating
- Existing Circuit : 30A
- Add-on Circuit : 25A
- Dielectric Strength for 60 seconds : AC1500V Min.
- Insertion & Extraction Force : 1Kg. Min.
- Contact Resistance at 1A DC : 5mΩ Max.
- Insulation Resistance at 500V DC : 100MΩ Min.
- Voltage Drop : 20mV Max.
- Temperature Rise : 50°C Max.
- Molded Parts : Nylon PA66 UL 94V-0,Black
- Terminals : Brass with Tin Plated
- Wire : #14 AWG UL 1015 Red Wire
- **Other color option is available for "Molded Parts" and "Wire"

Tolerances : Unless Otherwise Specified			
Dimension	Critical To Function	General	
< 1	+/-0.02	+/-0.03	
1 ~ 8	+/-0.1	+/-0.2	
8 ~ 24.995	+/-0.15	+/-0.25	
25 ~ 99.99	+/-0.2	+/-0.3	
Angles	+/-1°	+/-5°	
Rev	EN	Description	Dwg Ckd Appd Date
B	93092401	Modify the tolerance	Kao Chyi Ku 2004/9/24

Material		Material		Material	
Drawn	Check	Drawn	Check	Drawn	Check
Engr	Appd	Engr	Appd	Engr	Appd
Finish		Finish		Finish	
Unless Otherwise Specified Dimensions are mm (inch)		Unless Otherwise Specified Dimensions are mm (inch)		Unless Otherwise Specified Dimensions are mm (inch)	
Tolerances:		Tolerances:		Tolerances:	
.x = 1.0 (.04)		.x = 1.0 (.04)		.x = 1.0 (.04)	
.xx = 0.5 (.02)		.xx = 0.5 (.02)		.xx = 0.5 (.02)	
.xxx = 0.25 (.010)		.xxx = 0.25 (.010)		.xxx = 0.25 (.010)	
Title:		Title:		Title:	
Tiny Fuse(Micro 2) Tap		Tiny Fuse(Micro 2) Tap		Tiny Fuse(Micro 2) Tap	
(Left Side Insert Fuse)		(Left Side Insert Fuse)		(Left Side Insert Fuse)	
A4		A4		A4	
GTQD-HLD-1829-0903-401		GTQD-HLD-1829-0903-401		GTQD-HLD-1829-0903-401	
B		B		B	
Scale: 2:1		Scale: 2:1		Scale: 2:1	
Dwg Size		Dwg Size		Dwg Size	
Sht 1 of 1		Sht 1 of 1		Sht 1 of 1	
Rev		Rev		Rev	
Model File Name : Fuse Tap for Tiny Blade Fuse ; #14AWG Wire ; Left Side Insert		Model File Name : Fuse Tap for Tiny Blade Fuse ; #14AWG Wire ; Left Side Insert		Model File Name : Fuse Tap for Tiny Blade Fuse ; #14AWG Wire ; Left Side Insert	
Drawing File Name : GTQD-HLD-1829-0903-401		Drawing File Name : GTQD-HLD-1829-0903-401		Drawing File Name : GTQD-HLD-1829-0903-401	
Part Number : 1829 0903 401		Part Number : 1829 0903 401		Part Number : 1829 0903 401	
Date:		Date:		Date:	
2013/9/4		2013/9/4		2013/9/4	

GLORYTECH TECHNOLOGY CO., LTD.