

MOUNTING HOLES

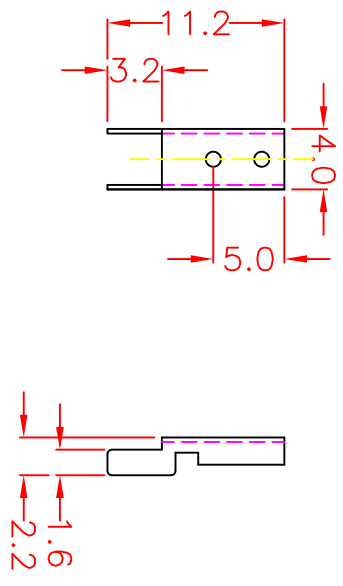
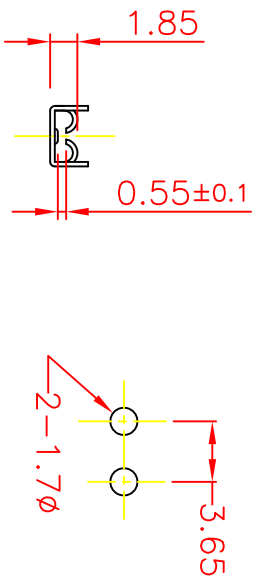

**SPECIFICATIONS:**

- Metal Material : Spring Bronze
- Material Thickness : 0.3t
- Suitable Rated Current : 15A Max.
- Insertion & Extraction Force : 1Kg. Min.
- Ambient Temperature :  $-40^{\circ}\text{C} \sim 85^{\circ}\text{C}$
- Finishing : \*= 4 for Bright Tin Plated  
 \*= 7 for Matte Tin Plated

Tolerances : Unless Otherwise Specified	
Dimension	Critical To Function
< 1	+/- 0.02
1 ~ 8	+/- 0.1
8 ~ 24.995	+/- 0.15
25 ~ 99.99	+/- 0.2
Angles	+/- 1°
Rev	EN
93092401	Modify the tolerance
	Dwng Kao
	Ckd Chyi
	Appd Ku
	Date 2004/9/24

Material	Drawn	Title:	Dwg Size	Sht	1	of	1	Rev
	Check							
Finish	Engr	P.C.B. Mount Fuse Clip	A	GTQD-CLP-4111-1101	B			
	Appd							
Unless Otherwise Specified Dimensions are mm (inch)		Scale:		2:1				
Tolerances:		.x = 1.0 (.04)						
		.xx = 0.5 (.02)						
		.xxx = 0.25 (.010)						
Model File Name : P.C.B. Mount Fuse Clip for Mini Blade Type Fuses		Date:		2004/9/24				
Drawing File Name : GTQD-CLP-4111-1101								
Part Number : 4111 1101 *24								