

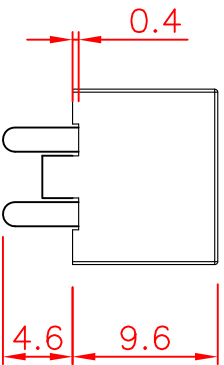

11.6

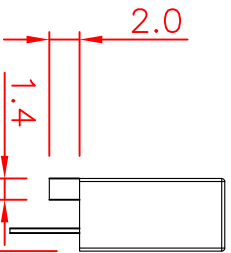

4.8



RECOMMENDED MOUNTING HOLE

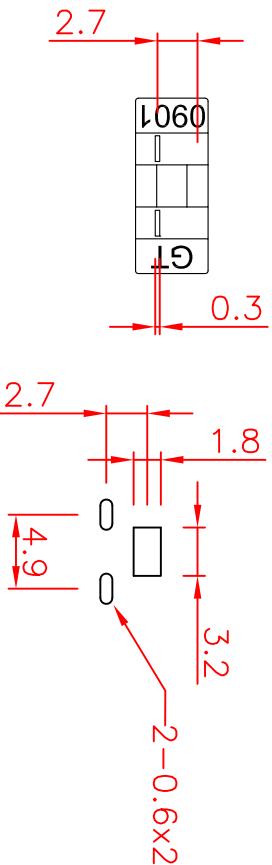

SPECIFICATIONS :

Dielectric Strength for 60 seconds : AC1500V Min.
 Insertion & Extraction Force : 1Kg. Min.
 Ambient Temperature : -40°C ~ 85°C
 Contact Resistance at 1A DC : 5mΩ Max.
 Insulation Resistance at 500V DC : 100MΩ Min.
 Voltage Drop : 20mV Max.
 Temperature Rise : 50°C Max.
 Molded Parts : Flame Retarding 94V0 Thermoplastic
 Terminals : Tin Plated

Part no.	Terminal Material	Finishing	Suitable Rated Current
1939 0901 400	Brass	Bright Tin Plated	15A Max.
1939 0901 700		Matte Tin Plated	
1939 0901 401	Phosphor Bronze	Bright Tin Plated	20A Max.
1939 0901 701		Matte Tin Plated	

Tolerances : Unless Otherwise Specified

Dimension	Critical To Function	General
< 1	+/- 0.02	+/- 0.03
1 ~ 8	+/- 0.1	+/- 0.2
8 ~ 24.995	+/- 0.15	+/- 0.25
25 ~ 99.99	+/- 0.2	+/- 0.3
Angles	+/- 1°	+/- 5°

Material	Drawn	Title:	A4	GTQD-BLK-1939-0901	C
	Check				
Finish	Engr	Tiny Blade Fuse Block	A4	GTQD-BLK-1939-0901	C
	Appd				
Unless Otherwise Specified Dimensions are mm (inch)					
Tolerances:					
.x = 1.0 (.04)					
.xx = 0.5 (.02)					
.xxx = 0.25 (.010)					
Scale:		2:1			
Dwg Size		Sht 1 of 1			
Rev		1			

Model File Name : Fuse Block for Tiny Blade Type Fuse

Drawing File Name : GTQD-BLK-1939-0901

Part Number : 1939 0901 40*

Date: 2018/9/20

Rev	EN	Description	Dwg	Ckd	Appd	Date
B	93092401	Modify the tolerance	Kao	Chyi	Ku	2004/9/24
C	107092001	底座修改	Kao	Chyi	Ku	2018/9/20