

**SPECIFICATIONS :**

Current Rating : 30Amps @500VAC  
 Contact : 0.4mm thick Brass, Tin Plated  
 Insulator : PBT, UL Rated 94 V-0  
 Temperature Rating : -50 °C ~ +145 °C

**Mounting Detail**

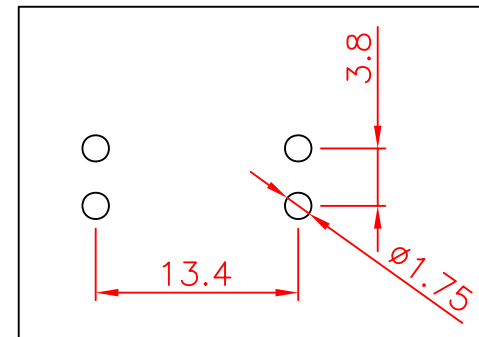

Tolerances : Unless Otherwise Specified		
Dimension	Critical To Function	General
< 1	+/- 0.02	+/- 0.03
1 ~ 8	+/- 0.1	+/- 0.2
8 ~ 24.995	+/- 0.15	+/- 0.25
25 ~ 99.99	+/- 0.2	+/- 0.3
Angles	+/- 1°	+/- 5°

Rev	EN	Description	Dwg	Ckd	Appd	Date
B	93092401	Modify the tolerance	Kao	Chyi	Ku	2004/9/24

Material	Drawn	<b>GLORYTECH TECHNOLOGY CO., LTD.</b>			
	Check				
Finish	Engr	Title: <b>P.C.B. Fuse Block</b>	A4	GTQD-BLK-1936-1101	B
	Appd				
Unless Otherwise Specified Dimensions are mm (inch) Tolerances: .x = 1.0 (.04) .xx = 0.5 (.02) .xxx = 0.25 (.010)		Scale: 2:1	Dwg Size	Sht 1 of 1	Rev
Model File Name : P.C.B. Fuse Block for Fuse Block for Standard / Mini / Low Profile Blade Fuse					
Drawing File Name : GTQD-BLK-1936-1101					
Part Number : 1936 1101 400			Date:	2012/2/10	