

Mounting Holes

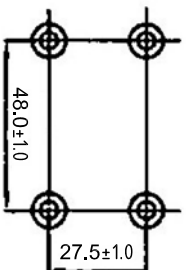

Terminal Dim.

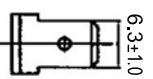

Material:

- Cover :PC.(Transparent)
- Housing & Base : PBT (Black)
- Push Button : POM.(White)
- Terminal : Copper with Tin plated

Notes:

Rating 100A max. tested by 4pcs 25A load

SPECIFICATIONS :

- Fuse Specifications : For Mini Blade Fuse
- Voltage : 32VDC Max.
- Input Terminal Rating : #10-32 threaded studs (100A max.)
- Output Terminal Rating : 30A max. per circuit.
- Connection Pad Option Available :
 - Input wire size : #4-6 AWG
 - Output wire size : #12-16 AWG
- Temperature Rating : -20°C ~ +85°C
- Torque Rating : 2.25 Nm(20 IN-LBS) Max.
- Mounting Torque Rating : 0.9 Nm(8 IN-LBS) Max.

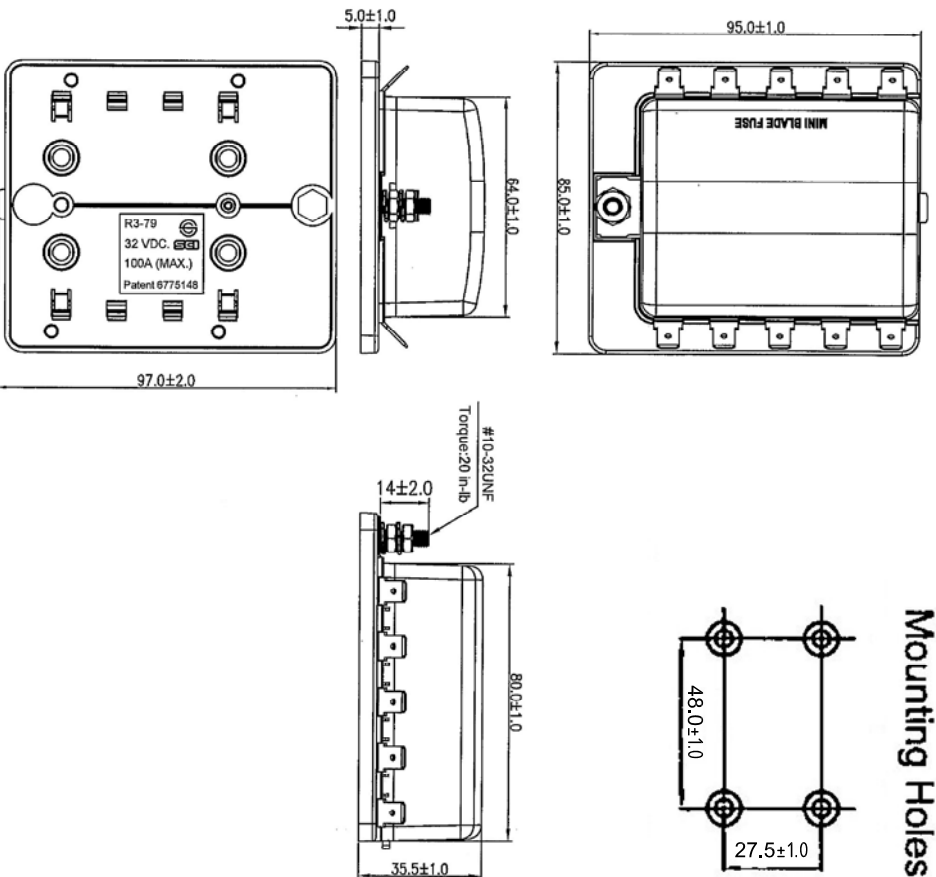

Tolerances : Unless Otherwise Specified	
Dimension	Critical To Function
< 1	+/- 0.02
1 ~ 8	+/- 0.1
8 ~ 24.995	+/- 0.15
25 ~ 99.99	+/- 0.2
Angles	+/- 1°
Rev	EN
93092401	Modify the tolerance
	Dwg Kao
	Ckd Chyi
	Appd Ku
	Date 2004/9/24

Material	Drawn	Title:	A4	GTQD-BLK-1916-1310620	B
	Check				
Finish	Engr	Unless Otherwise Specified Dimensions are mm (inch)	Scale:	Dwg Size	Sht 1 of 1
	Appd				
Tolerances:		Model File Name : Mini Blade Fuse Box(10 Position)	Date:	2020/10/27	Rev
.x = 1.0 (.04)					
.xx = 0.5 (.02)		Drawing File Name : GTQD-BLK-1916-1310620			
.xxx = 0.25 (.010)		Part Number : 1916 1310 620			

GLORYTECH TECHNOLOGY CO., LTD.