

**Mounting Holes**

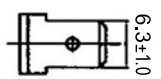

**Terminal Dim.**

**Material:**  
 Cover : PC (Transparent)  
 Housing & Base : PBT (Black)  
 Push Button : POM (White)  
 Terminal : Copper with Tin plated

**Notes:**  
 Rating 100A max. tested by 4pcs 25A load

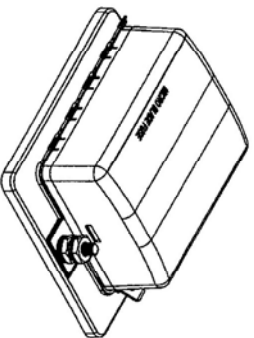
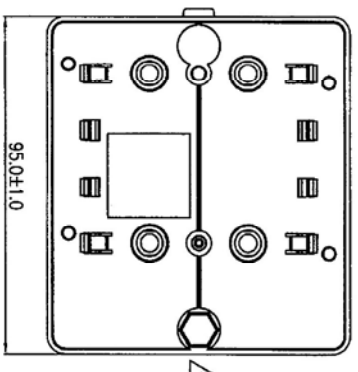
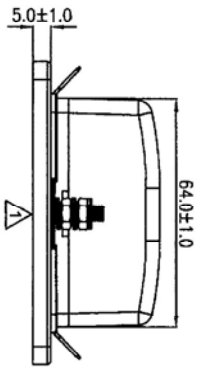
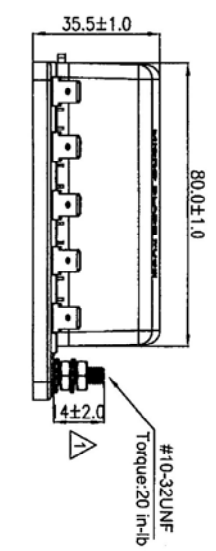

**SPECIFICATIONS :**  
 Fuse Specifications : For Micro Blade Fuse  
 Voltage : 32VDC Max.  
 Input Terminal Rating : #10-32 threaded studs (100Amax.)  
 Output Terminal Rating : 30A max. per circuit.  
 Connection Pad Option Available :  
 Input wire size : #4-6 AWG  
 Output wire size : #12-16 AWG  
 Temperature Rating : -20°C ~ +85°C  
 Torque Rating : 2.25 Nm(20 IN-LBS) Max.  
 Mounting Torque Rating : 0.9 Nm(8 IN-LBS) Max.

Tolerances : Unless Otherwise Specified	
Dimension	Critical To Function
< 1	+/-0.02
1 ~ 8	+/-0.1
8 ~ 24.995	+/-0.15
25 ~ 99.99	+/-0.2
Angles	+/- 1°
Rev	EN
93092401	Modify the tolerance
	Dwg Kao
	Ckd Chyi
	Appd Ku
	Date 2004/9/24

Material	Drawn	Title: <b>GLORYTECH TECHNOLOGY CO., LTD.</b>	
	Check		
Finish	Engr	Micro Blade Fuse Box	A4
	Appd		
Unless Otherwise Specified Dimensions are mm (inch)		Scale:	Dwg Size
Tolerances: .x = 1.0 (.04) .xx = 0.5 (.02) .xxx = 0.25 (.010)			
Model File Name : Micro Blade Fuse Box(10 Position)		Sht	1 of 1
Drawing File Name : GTQD-BLK-1916-1310462		Date:	2020/10/27
Part Number : 1916 1310 462			