

Fast Acting Glass Tube Fuse

Part No. **1104** series

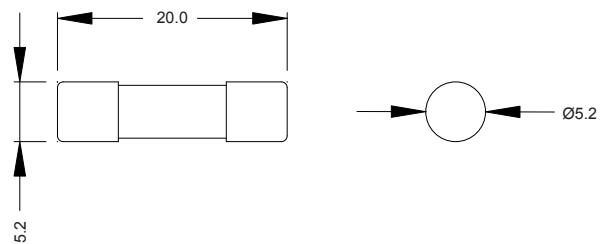

- Fast Acting Glass Tube Fuses
- 5ø x 20 mm (0.197 x 0.787 Inch)
- Caps: Brass With Nickel Plating
- Body: Glass Tube
- Standards: UL & CSA 248-14
- Element: Silver Alloy
- Ampere Rating: 0.5 – 25 A
- Voltage Rating: 250V and Less



Scale: mm

Specifications

Opening Time / Pre-arcing Time:

In	1.0 In	1.35 In	2.0 In
0.5 - 25A	> 4 Hours	Max.	Max.
		1 Hour	10 s

Ordering Information:

Part No.	Ampere (A)	Voltage (V)	Cold Resistance Ω	Voltage Drop Max. (mV)	Breaking Capacity AC	I ² t Min. (A ² S)
11040500200	500 mA	250 V	0.46	250	35A 250V	0.07
11040630200	630 mA	250 V	0.30	230	35A 250V	0.14
11040800200	800 mA	250 V	0.19	200	35A 250V	0.26
11041100200	1 A	250 V	0.15	180	35A 250V	0.48
11041125200	1.25 A	250 V	0.11	170	100A 250V	1.13
11041160200	1.6 A	250 V	0.078	150	100A 250V	2.10
11041200200	2 A	250 V	0.06	130	100A 250V	2.70
11041250200	2.5 A	250 V	0.044	120	100A 250V	5.60
11041300200	3 A	250 V	0.040	117	100A 250V	7.50
11041315200	3.15 A	250 V	0.035	115	100A 250V	8.60
11041400200	4 A	250 V	0.025	105	200A 250V	17.5
11041500200	5 A	250 V	0.019	100	200A 250V	28.50
11041600200	6 A	250 V	0.017	97	200A 250V	40.30
11041630200	6.3 A	250 V	0.015	95	200A 250V	49.00
11041800200	8 A	250 V	0.011	90	200A 250V	96.00
11042100200	10 A	250 V	0.0085	85	200A 250V	110.00
11042120200	12 A	250 V	0.0075	90	200A 250V	210.00
11042150200	15 A	250 V	0.005	75	200A 250V	450.00
11042200200	20 A	250 V	0.0035	70	200A 250V	800.00
11042250200	25 A	250 V	0.002	60	200A 250V	1250.00